

MALTA TOWNSHIP SECTION 27 R-12 TWP-10 MORGAN COUNTY, OH

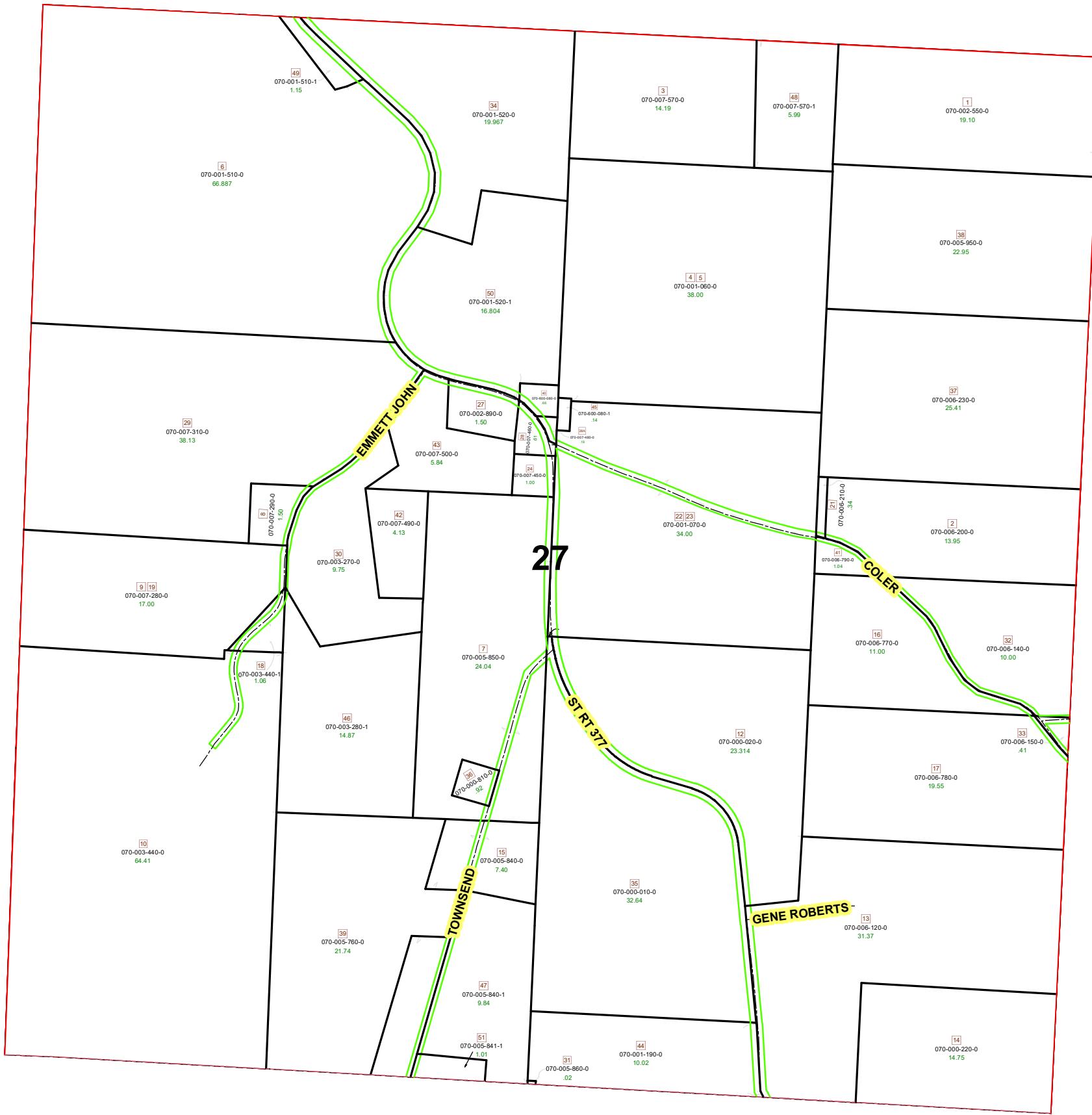

PIN	VOL	PAG	Owner	LegalDescr	Acres
070-001-510-1	OR231	5000	1ST MORGAN PROPERTIES LLC	R12 T10 S27 SD 49	1.159
070-000-020-0	OR230	2598	ABER WILLIAM A & REBECCA L	R12 T10 S27 SD 12	23.314
070-000-010-0	OR218	1596	ABER WILLIAM ALLEN	R12 T10 S27 SD 35	32.639
070-001-190-0	OR196	237	ANTILL DUANE E	R12 T10 S27 SD 44	10.025
070-000-220-0	D.V 177	629	BAKER FRED A & DIANA S	R12 T10 S27 SD 14	14.75
070-001-070-0	D.V 189	793	BRASKETT KENNETH R & MARLENE R	R12 T10 S27 SD 22-	34
070-000-810-0	D.V 164	123	BURCHER RICHARD S & MARY A	R12 T10 S27 SD 36	0.92
070-007-480-0	OR171	483	FINK MICHAEL J	R12 T10 S27 SD 28	0.193
070-600-080-0	OR171	483	FINK MICHAEL J	R12 T10 S27 SD 40	0.661
070-001-060-0	OR234	4608	GONYA KENNETH A & CORY	R12 T10 S27 SD 4-5	38
070-007-460-0	D.V 202	3013	HARRIS THOMAS H & ELLEN E	R12 T10 S27 SD 28	0.61
070-002-890-0	D.V 164	315	HARRIS THOMAS H & ELLEN E	R12 T10 S27 SD 27	1.5
070-007-450-0	D.V 202	3013	HARRIS THOMAS H & ELLEN E	R12 T10 S27 SD 24	1
070-600-080-1	D.V 203	43	MALTA TWP	R12 T10 S27 SD 45	0.14
070-007-490-0	OR229	224	MCDANIEL WILLIAM T	R12 T10 S27 SD 42	4.13
070-007-500-0	OR229	224	MCDANIEL WILLIAM T	R12 T10 S27 SD 43	5.84
070-007-570-1	OR81	630	MILLER JAMES B & CHERYL D	R12 T10 S27 SD 48	5.992
070-007-570-0	OR202	3185	MILLER JAMES B & CHERYL D	R12 T10 S27 SD 3 S	14.198
070-005-840-0	D.V 180	597	RAY DANNY & WENDY	R12 T10 S27 SD 15	7.402
070-005-850-0	OR185	510	RAY DANNY & WENDY	R12 T10 S27 SD 7 S	24.04
070-005-760-0	D.V 160	705	RAY DANNY L & WENDY JO	R12 T10 S27 SD 89	21.74
070-005-950-0	OR218	2855	RHEYNE MARK ANTHONY	R12 T10 S27 SD 38	22.95
070-001-520-0	OR234	264	ROBERTS RYAN EDWARD & SERAPHI	R12 T10 S27 SD 34	19.967
070-006-150-0	OR47	27	ROBERTS STEPHEN E	R12 T10 S27 SD 33	0.41
070-006-140-0	OR92	275	ROBERTS STEPHEN E	R12 T10 S27 SD 32	10
070-006-200-0	OR92	275	ROBERTS STEPHEN E	R12 T10 S27 SD 2	13.955
070-006-230-0	OR92	275	ROBERTS STEPHEN E	R12 T10 S27 SD 37	25.41
070-006-210-0	OR92	275	ROBERTS STEPHEN E	R12 T10 S27 SD 21	0.34
070-006-120-0	OR205	1903	ROBERTS STEPHEN E & ANGIE S	R12 T10 S27 SD 13	31.37
070-003-440-0	OR233	3054	RURAL FARMS LLC	R12 T10 S27 SD 10-	64.413
070-003-440-1	OR233	3054	RURAL FARMS LLC	R12 T10 S27 SD 18	1.062
070-006-780-0	D.V 188	107	SLOWTER D JEAN	R12 T10 S27 SD 17	19.553
070-006-770-0	D.V 188	107	SLOWTER D JEAN	R12 T10 S27 SD 16	11
070-006-790-0	D.V 188	107	SLOWTER D JEAN	R12 T10 S27 SD 41	1.045
070-002-550-0	OR231	1847	SYCK FAMILY TRUST SYCKS HARRY	R12 T10 S27 SD 1	19.1
070-005-841-1	OR222	2398	TAYLOR RYAN L	R12 T10 S27 SD 51	1.011
070-005-840-1	OR222	2401	TAYLOR RYAN L	R12 T10 S27 SD 47	9.847
070-007-280-0	OR215	2624	TOMES TREES LLC	R12 T10 S27 SD 9-1	17
070-007-290-0	OR215	2624	TOMES TREES LLC	R12 T10 S27 SD 8	1.5
070-007-310-0	OR215	2624	TOMES TREES LLC	R12 T10 S27 SD 29	38.13
070-001-510-0	OR224	2978	TROYER AMMON, MIRIAM & DANIEL	R12 T10 S27 SD 6 S	66.887
070-003-270-0	OR229	2538	WHEELER KATHLEEN TOME	R12 T10 S27 SD 30	9.754
070-001-520-1	OR210	2991	WHISMAN BRIAN K & KELLY J	R12 T10 S27 SD 50	16.804
070-003-280-1	OR215	3418	WHITTA RONALD E & WILLIAM S	R12 T10 S27 SD 46	14.871



Boundaries

- Hidden (dashed line)
- ROW (green line)
- Hydro (blue line)
- Section (red line)
- Roads (black line)
- Lot (yellow line)
- Township (dotted line)
- County (grey line)
- Parcel (black line)
- Parcels (white box)

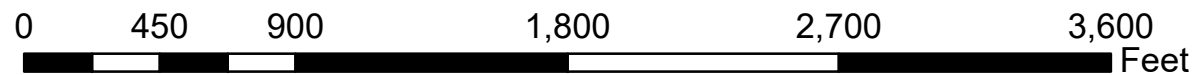

Disclaimer: The information that these maps contains is for reference purposes only. Please bring any erros to the attention of the Engineer's Office staff.
Thank you

Source: Morgan County Engineer's Office
Author: Marcia Wolfe
Date: 6/24/2020